

1350

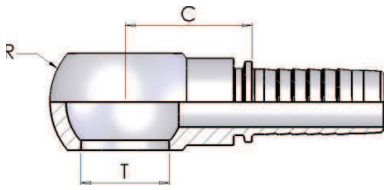

Metric Banjo

Product number	hose I.D.		Dimension				
	in	mm	dash size	hole T	mm	R	Cut-off C
1350-03-10	3/16	4.8	03	M10-1	10.2	17	25
1350-03-12	3/16	4.8	03	M12-1.5	12.2	20	22
1350-04-10	1/4	6.4	04	M10-1	10.2	17	25
1350-04-12	1/4	6.4	04	M12-1.5	12.2	20	22
1350-04-14	1/4	6.4	04	M14-1.5	14.2	24	26
1350-05-14	5/16	7.9	05	M14-1.5	14.2	24	26
1350-05-16	5/16	7.9	05	M16-1.5	16.2	28	26
1350-05-18	5/16	7.9	05	M18-1.5	18.2	32	29
1350-06-14	3/8	9.5	06	M14-1.5	14.2	24	26
1350-06-16	3/8	9.5	06	M16-1.5	16.2	28	26
1350-06-18	3/8	9.5	06	M18-1.5	18.2	32	29
1350-06-22	3/8	9.5	06	M22-1.5	22.2	36	31
1350-08-16	1/2	12.7	08	M16-1.5	16.2	28	27
1350-08-18	1/2	12.7	08	M18-1.5	18.2	32	29
1350-08-22	1/2	12.7	08	M22-1.5	22.2	36	31
1350-10-22	5/8	15.9	10	M22-1.5	22.2	36	31
1350-10-26	5/8	15.9	10	M26-1.5	26.5	45	38
1350-12-22	3/4	19	12	M22-1.5	22.2	36	32
1350-12-26	3/4	19	12	M26-1.5	26.2	46	38
1350-16-30	1	25.4	16	M30-2	30.2	54	45