

1800

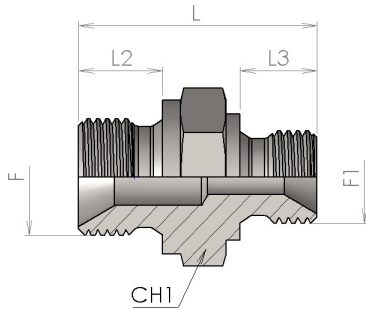

Reducing BSP Niple (ISO 8434-6)

S

Product number	Ø tube		Thread		Dimension				Weight kg/unit
	mm	inch	F	F1	L	L2	L3	CH1	
1800-04-02	8-6	5/16"-1/4"	G 1/4	G 1/8	28.5	11	8	19	0.028
1800-06-02	10-6	3/8"-1/4"	G 3/8	G 1/8	31	12	8	22	0.041
1800-06-04	10-8	3/8"-5/16"	G 3/8	G 1/4	34	12	11	22	0.045
1800-08-04	12-8	1/2"-5/16"	G 1/2	G 1/4	37.5	14	11	27	0.072
1800-08-06	12-10	1/2"-3/8"	G 1/2	G 3/8	39.5	14	12	27	0.08
1800-10-08	16-12	5/8"-1/2"	G 5/8	G 1/2	41	16	14	30	0.097
1800-12-04	20-8	3/4"-5/16"	G 3/4	G 1/4	40	16	11	32	0.105
1800-12-06	20-10	3/4"-3/8"	G 3/4	G 3/8	43	16	12	32	0.118
1800-12-08	20-12	3/4"-1/2"	G 3/4	G 1/2	45	16	14	32	0.134
1800-12-10	20-16	3/4"-5/8"	G 3/4	G 5/8	46	16	16	32	0.126
1800-16-06	25-10	1"-3/8"	G 1	G 3/8	45.5	19	12	41	0.174
1800-16-08	25-12	1"-1/2"	G 1	G 1/2	48	19	14	41	0.185
1800-16-10	25-16	1"-5/8"	G 1	G 5/8	49	19	16	41	0.192
1800-16-12	25-20	1"-3/4"	G 1	G 3/4	49	19	16	41	0.19
1800-20-12	32-20	1.1/4"-3/4"	G 1 1/4	G 3/4	54	20	16	50	0.32
1800-20-16	32-25	1.1/4"-1"	G 1 1/4	G 1	55	20	19	50	0.323
1800-24-12	38-20	1.1/2"-3/4"	G 1 1/2	G 3/4	54	22	16	55	0.41
1800-24-16	38-25	1.1/2"-1"	G 1 1/2	G 1	59	22	19	55	0.414
1800-24-20	38-32	1.1/2"-1.1/4"	G 1 1/2	G 1 1/4	60	22	20	55	0.6
1800-32-16	50-25	2"-1"	G 2	G 1	64	22	19	70	0.612
1800-32-20	50-32	2"-1.1/4"	G 2	G 1 1/4	65.5	25	20	70	0.72
1800-32-24	50-38	2"-1.1/2"	G 2	G 1 1/2	67.5	25	22	70	0.735