

WELDING BULKHEAD CONNECTION

Type: **1056...1** Body

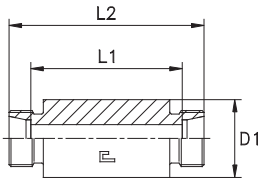

Type: **1056..** B3 Ring

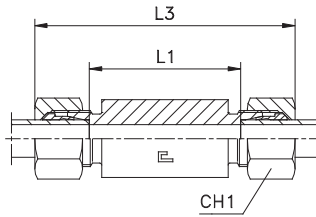

Type: **1056...4** B4 Ring

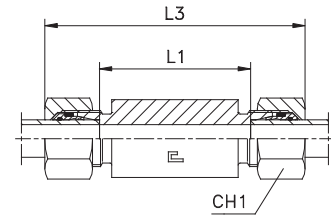

Series DIN	10.... [bar]	11.... [bar]	Ordering Body	Ordering Equipped B3	Ø Tube	D1	L1	L2	L3	CH1	Ordering Equipped B4
L	315	315	105604.1	105604	6	18	56	70	85	14	105604.4
			105605.1	105605	8	20	56	70	85	17	105605.4
			105606.1	105606	10	22	58	72	87	19	105606.4
			105607.1	105607	12	25	58	72	87	22	105607.4
			105608.1	105608	15	28	70	84	100	27	105608.4
	105609.1	105609	18	32	69	84	101	32	105609.4		
	160	160	105610.1	105610	22	36	73	88	105	36	105610.4
			105611.1	105611	28	40	73	88	106	41	105611.4
			105612.1	105612	35	50	71	92	114	50	105612.4
			105613.1	105613	42	60	70	92	115	60	105613.4
105614.1			105614	6	20	60	74	89	17	105614.4	
S	630	630	105615.1	105615	8	22	60	74	89	19	105615.4
			105616.1	105616	10	25	59	74	91	22	105616.4
			105617.1	105617	12	28	59	74	91	24	105617.4
			105618.1	105618	14	30	72	88	107	27	105618.4
			105619.1	105619	16	35	71	88	107	30	105619.4
	400	400	105620.1	105620	20	38	71	92	114	36	105620.4
			105621.1	105621	25	45	72	96	120	46	105621.4
			105622.1	105622	30	50	73	100	126	50	105622.4
			105623.1	105623	38	60	72	104	133	60	105623.4
			315	315	105623.1	105623	38	60	72	104	133

Note: If you wish to order AISI 316 stainless steel fittings, please change the first two digits from **10....** to **11....** .
If you wish to order AISI 316 stainless steel fittings with AISI 304 stainless steel nuts, please change the first two digits from **10....** to **14....** .

WELDING NIPPLE WITH O-RING

Delivered separately (unassembled)

Type: **1057..**

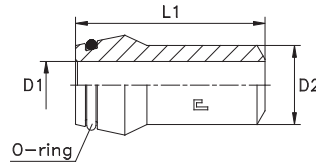

Series DIN	10.... [bar]	11.... [bar]	Ordering Complete	Thickness	Ø Tube	D1	D2	L1
L/S	630	630	105701	6x1.75	6	2.5	6	31
			105702	8x2	8	4	8	31
	315	315	105703	10x1.5	10	7	10	32.5
			105704	10x2	10	6	10	32.5
	400	400	105705	12x1.5	12	9	12	32.5
			105706	12x2	12	8	12	32.5
630	630	105707	12x2.5	12	7	12	32.5	
L	315	315	105708	15x2.5	15	10	15	34
			105709	18x2.5	18	13	18	35.5
	160	160	105710	22x2.5	22	17	22	38.5
			105711	28x2.5	28	23	28	41.5
			105712	35x3	35	29	35	47.5
105713	42x3	42	36	42	47.5			
S	400	400	105714	14x3	14	8	14	38.5
	250	250	105715	16x2	16	12	16	39
	315	315	105716	16x2.5	16	11	16	39
	400	400	105717	16x3	16	10	16	39
	250	250	105718	20x2.5	20	15	20	45
	315	315	105719	20x3	20	14	20	45
	400	400	105720	20x4	20	12	20	45
	250	250	105721	25x3	25	19	25	49.5
	315	315	105722	25x4	25	17	25	49.5
	400	315	105723	25x5	25	15	25	49.5
	160	160	105724	30x3	30	24	30	52
	250	250	105725	30x4	30	22	30	52
	315	315	105726	30x5	30	20	30	52
			105727	30x6	30	18	30	52
	160	160	105728	38x3	38	32	38	56.5
	250	250	105729	38x5	38	28	38	56.5
315	315	105730	38x6	38	26	38	56.5	
		105731	38x8	38	22	38	56.5	

Note: If you wish to order a fitting in stainless steel, please change the first two digit from **10....** to **11....** .