

# 3900

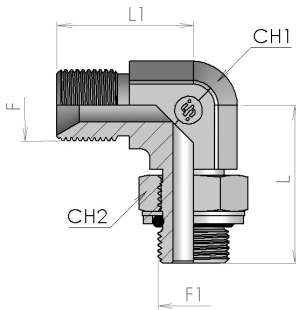

## 90° Adjustable stud elbow BSP-BSP (ISO 1179)

**SDE**

Product number	Ø tube		Thread		Dimension				Weight
	mm	inch	F	F1	L	L1	CH1	CH2	kg/unit
3900-02-02	6	1/4"	G 1/8	G 1/8	27	22	12	14	0.028
3900-04-02	8-6	5/16"-1/4"	G 1/8	G 1/4	33	24.5	14	19	0.045
3900-04-04	8	5/16"	G 1/4	G 1/4	33	27	14	19	0.05
3900-04-06	8-10	5/16"-3/8"	G 3/8	G 1/4	35	32	19	19	0.084
3900-06-02	10-6	3/8"-1/4"	G 1/8	G 3/8	37	27	19	22	0.087
3900-06-04	10-8	3/8"-5/16"	G 1/4	G 3/8	37	29.5	19	22	0.091
3900-06-06	10	3/8"	G 3/8	G 3/8	37	32	19	22	0.094
3900-06-08	10-12	3/8"-1/2"	G 1/2	G 3/8	40	36	22	22	0.14
3900-08-04	12-8	1/2"-5/16"	G 1/4	G 1/2	43	31.5	22	27	0.135
3900-08-06	12-10	1/2"-3/8"	G 3/8	G 1/2	43	34	22	27	0.142
3900-08-08	12	1/2"	G 1/2	G 1/2	43	36	22	27	0.147
3900-08-12	12-20	1/2"-3/4"	G 3/4	G 1/2	46.5	42	27	27	0.224
3900-12-06	20-10	3/4"-3/8"	G 3/8	G 3/4	50	37	27	36	0.231
3900-12-08	20-12	3/4"-1/2"	G 1/2	G 3/4	50	39	27	36	0.239
3900-12-12	20	3/4"	G 3/4	G 3/4	50	42	27	36	0.248
3900-12-16	20-25	3/4"-1"	G 1	G 3/4	50	44	33	36	0.31
3900-16-12	25-20	1"-3/4"	G 3/4	G 1	53	44	33	41	0.37
3900-16-16	25	1"	G 1	G 1	53	46	33	41	0.374
3900-16-20	25-32	1"-1.1/4"	G 1.1/4	G 1	55.5	52	41	41	0.469
3900-20-16	32-25	1.1/4"-1"	G 1	G 1.1/4	58	49	41	50	0.564
3900-20-20	32	1.1/4"	G 1.1/4	G 1.1/4	58	52	41	50	0.658
3900-24-24	38	1.1/2"	G 1.1/2	G 1.1/2	63	59	50	55	0.97