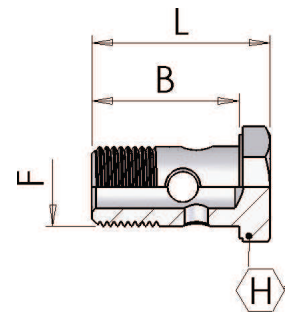

**1650****Metric perforated bolt**

| Product number | Dimension |    |    |    |
|----------------|-----------|----|----|----|
|                | F         | B  | L  | H  |
| 1650-00-10     | M10-1     | 19 | 24 | 14 |
| 1650-00-12     | M12-1.5   | 26 | 31 | 17 |
| 1650-00-14     | M14-1.5   | 29 | 34 | 19 |
| 1650-00-16     | M16-1.5   | 33 | 41 | 22 |
| 1650-00-18     | M18-1.5   | 37 | 44 | 24 |
| 1650-00-22     | M22-1.5   | 38 | 46 | 27 |
| 1650-00-26     | M26-1.5   | 47 | 56 | 32 |
| 1650-00-30     | M30-1.5   | 58 | 68 | 36 |